

# INSTALLATION AND SERVICE MANUAL

**Ligman**  
LIGHTING USA

For Installation of Jet 51-54 RGBW cylindrical and square wall down and up-down light.  
Model. UJE-30393, UJE-30413, UJE-30383 and UJE-30403.

## Product drawing (dimensions)

SUITABLE FOR WET LOCATIONS

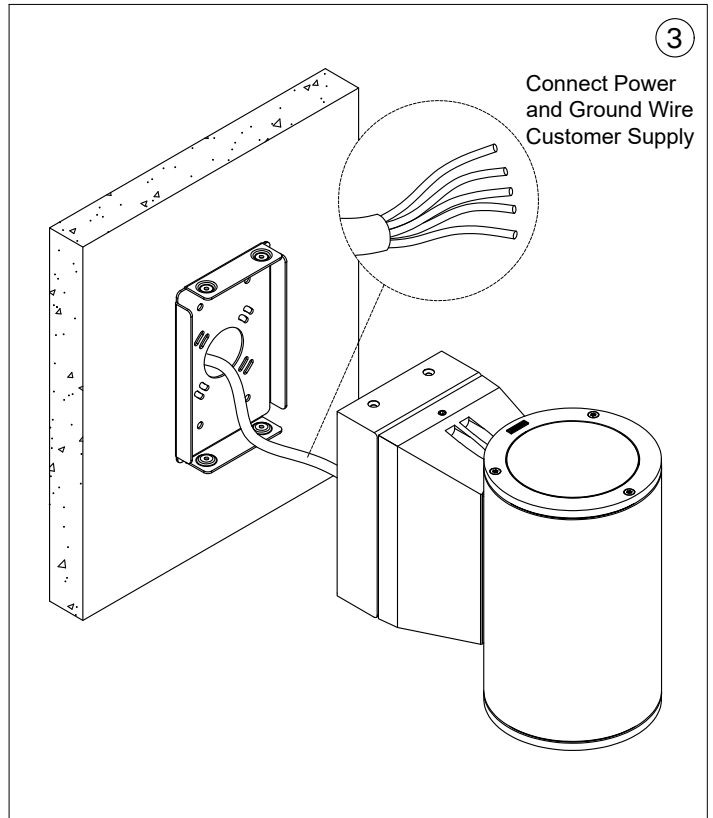
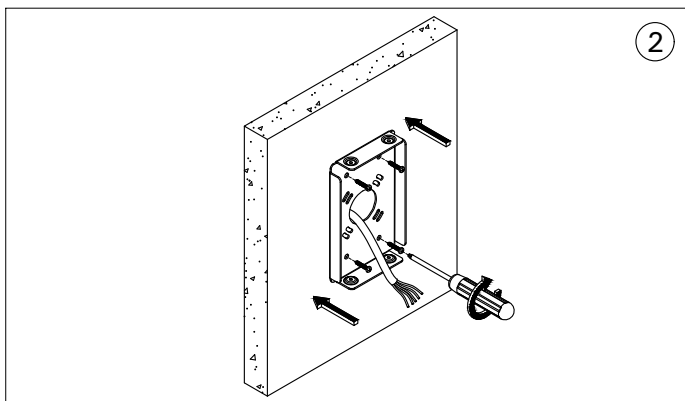
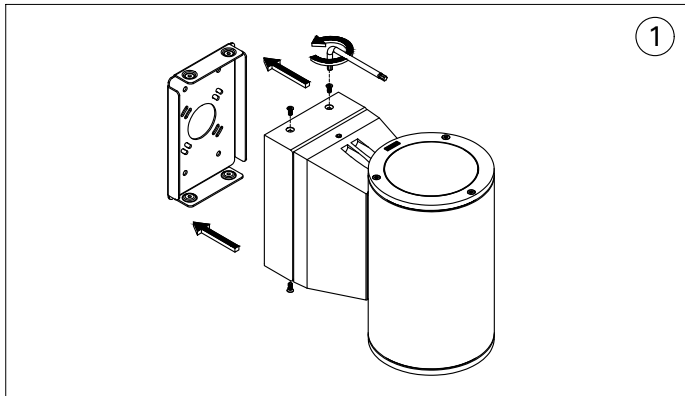
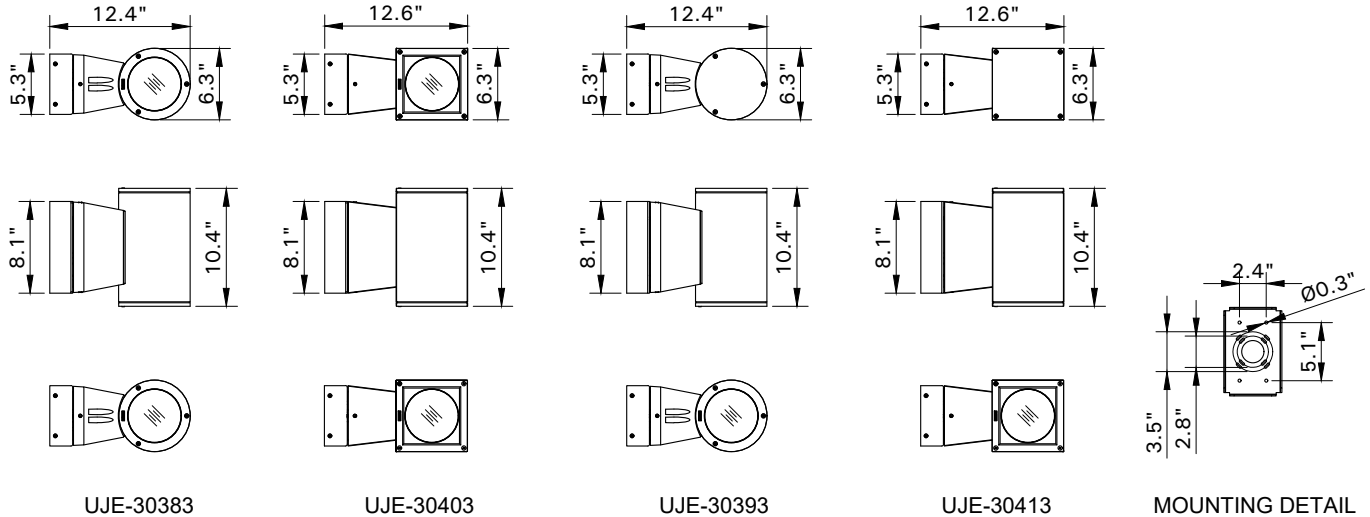

## Notice to installer :

- 1.WIRING INSTRUCTIONS Warning :** RISK OF FIRE AND ELECTRICAL SHOCK. : FIXTURE MUST BE INSTALLED BY A QUALIFIED ELECTRICIAN ONLY>FIXTURE IS INTENDED FOR INSTALLATION IN ACCORDANCE WITH THE NATIONAL ELECTRICAL CODE, LOCAL AND FEDERAL CODE SPECIFICATIONS. DISCONNECT POWER BEFORE SERVICING.
- 2.This fixture has a VOLTAGE SPECIFIC BALLAST,**Check that the supply voltage is the same as the installed ballast voltage.

**Ligman Lighting USA**

7144 NE Progress Court, Hillsboro  
Oregon, 97124, USA  
Tel : 503 645 0500 | Fax : 503 645 8100

4

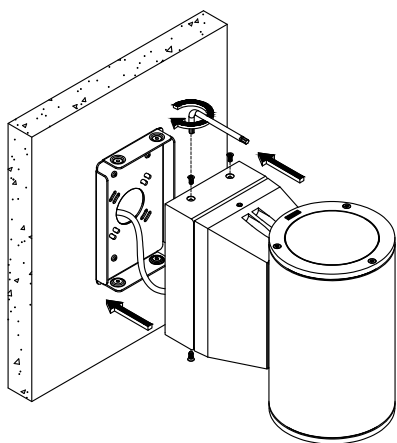

5

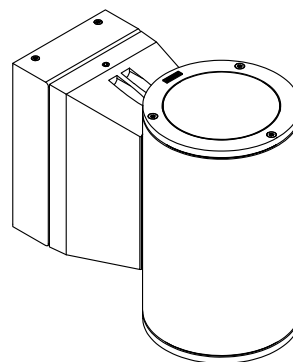

### DMX SYSTEM BLOCK DIAGRAM

